

KEY FEATURES

- Designed for a wide range of marine and industrial applications
- Multiple of optical distribution patterns for superior lighting quality
- Field serviceable LED light engines, power supply, and components
- Approved for through-wiring of several units on a single circuit
- Optimized thermal management of electronics for longevity
- Built-in junction area for simplified termination
- 8 mounting options for installation flexibility



TECHNICAL SPECIFICATIONS / MAXIMUM RATINGS

| | |
|--------------------|--|
| HOUSING | Copper free aluminium and polycarbonate lens |
| MOUNTING | See pages 3 and 4 for MOUNTING OPTIONS |
| INPUT VOLTAGE | AC: 120-277VAC (50/60 Hz) HV: 347VAC±10%VAC (50/60 Hz) |
| POWER (TYP) | MR3: AC - 30W HV - 35W MR6: AC - 60W HV - 69W |
| CURRENT (TYP) | MR3: AC - 0.25A@120 VAC HV - 0.10A@347 VAC MR6: AC - 0.50A@120 VAC HV - 0.20A@347 VAC |
| CONNECTIONS | 3x 3/4" NPT entries |
| DIMMING | 0-10V Dimmable, Class 1 wiring See CHART on page 2 |
| TEMPERATURE RANGE | -40°C to +55°C (Case ~20°C above ambient) |
| CERTIFICATIONS | Certified to UL 1598, UL 1598A & UL 8750; CSA C22.2 No. 250.0, CSA C22.2 No. 250.13 |
| INGRESS PROTECTION | IP66/67 Suitable for wet locations. |
| COLOUR TEMP RANGE | 50: 5000K Special Order: 2700-6500K |
| CRI VALUE (MIN) | 50: 70 |
| TOTAL LUMENS | See CHART on page 2 |
| LUMEN MAINTENANCE | LM-80 > 60,000 hrs |
| WEIGHT | 4.6 kg 10.4 lbs |

* The ambient temperature during lifetime, lumen and chromaticity determination is 25°C ± 1°C.

DIMENSIONS

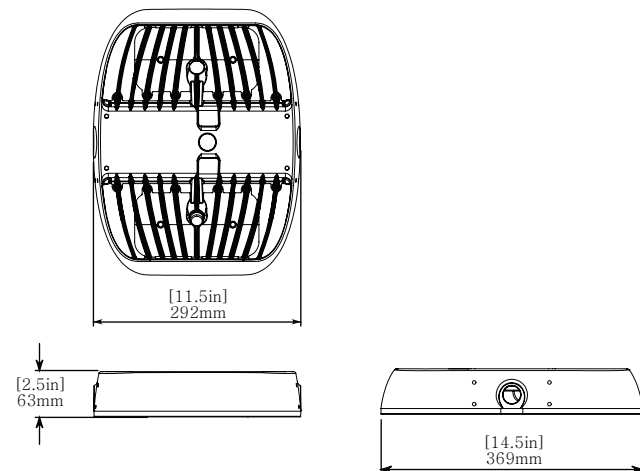

WARRANTY

Five (5) year limited warranty to the original purchaser. The warranty covers defects in materials and workmanship under normal use and service.

For additional information see: <https://nemalux.com/legal>

OPTIC OPTIONS

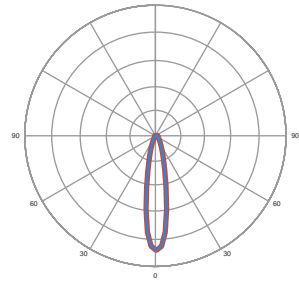
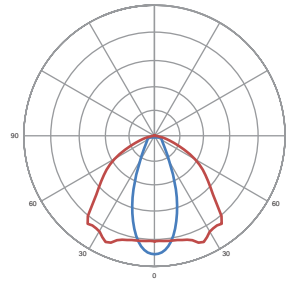
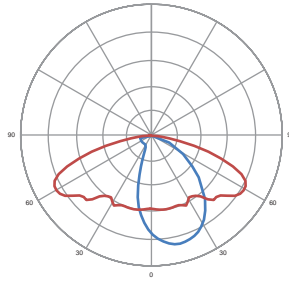
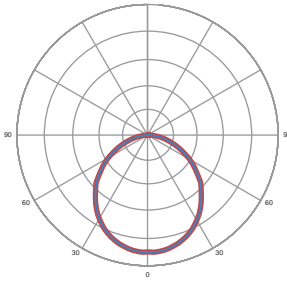

AC & HV MODELS (5000K CCT, minimum 70CRI)

WF - Wide Beam (No Optic)

| LUMEN OUTPUT (50) | |
|-------------------|------|
| MR3 | 3393 |
| MR6 | 6283 |

T2F - IESNA Type 2

| LUMEN OUTPUT (50) | |
|-------------------|------|
| MR3 | 2980 |
| MR6 | 5520 |

OF - Oval 26° x 108°

| LUMEN OUTPUT (50) | |
|-------------------|------|
| MR3 | 3290 |
| MR6 | 6090 |

SF - Spot 18°

| LUMEN OUTPUT (50) | |
|-------------------|------|
| MR3 | 3380 |
| MR6 | 6265 |

*Note: Standard offering above, 13 alternate optical profiles available upon request.
Contact Nemalux Sales representative for further details. Minimum order quantities, additional costs and lead times may apply.*

PHOTOMETRICS

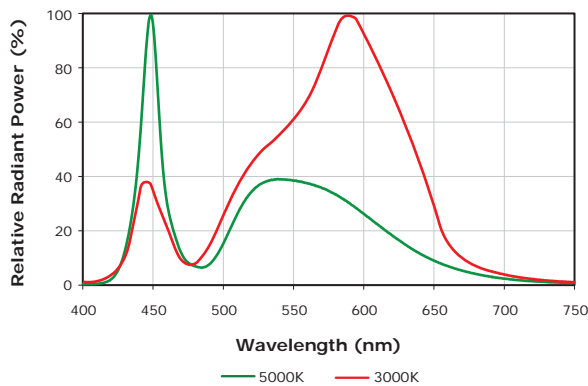

DIMMING

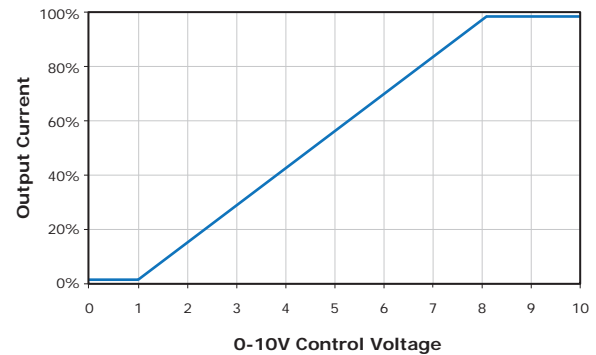

- Driver will source a maximum of 200uA for control needs
- Controller must sink current from the 0-10V control leads

MOUNTING OPTIONS (Order Separately)

SURFACE MOUNT (MR-SM) : 5.3 kg | 11.7 lbs

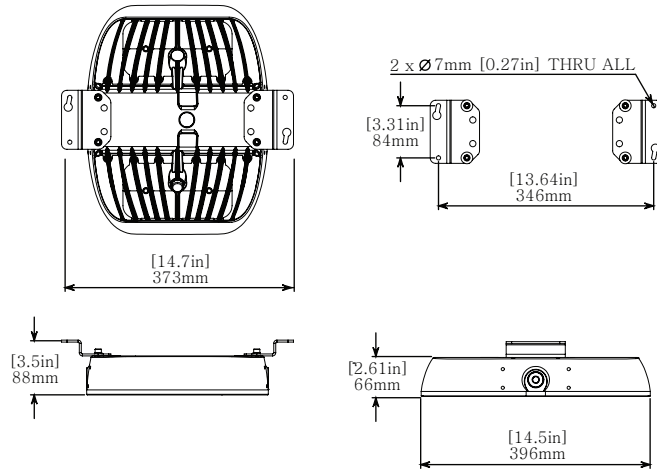

SUSPENDED MOUNT (MR-SM) : 5.3 kg | 11.7 lbs

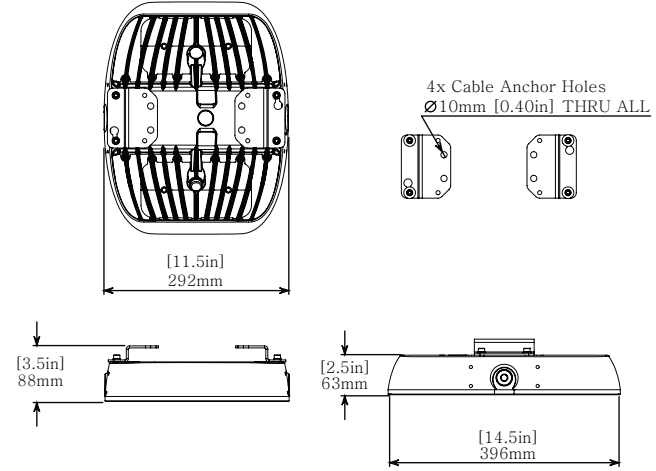

WALL MOUNT 2 (MR-WM2) : 5.8 kg | 12.9 lbs

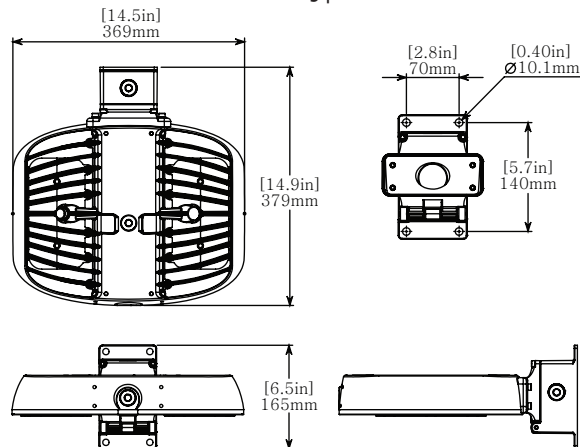

YOKE MOUNT (MR-YM) : 6.2kg | 13.9lbs | EPA: 0.12 m² / 1.29 ft²

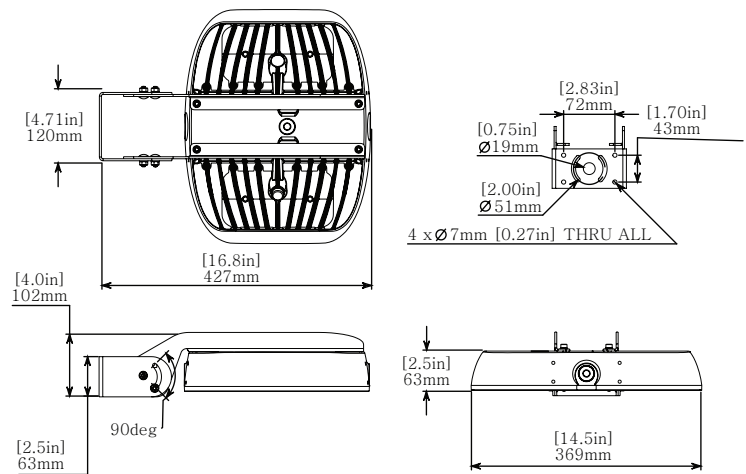

POLE MOUNT (MR-PM-GY) : 5.64 kg | 12.4 lbs | EPA: 0.04 m² / 0.44 ft²

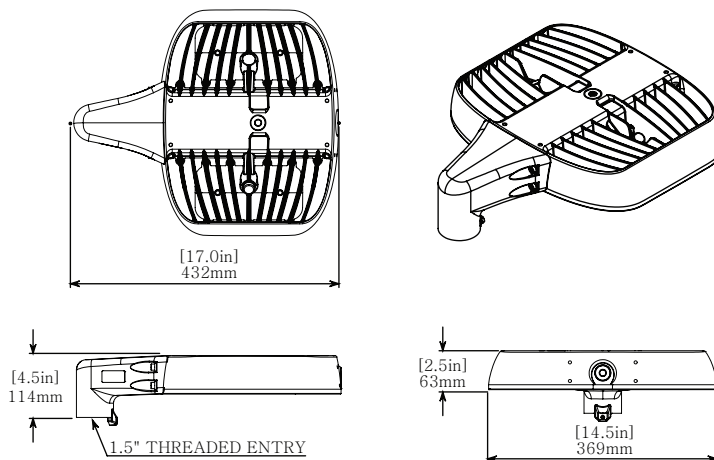

MOUNTING OPTIONS (Order Separately)

HOOK PENDANT MOUNT (MR-HK-GY) : 5.0 kg | 11.3 lbs

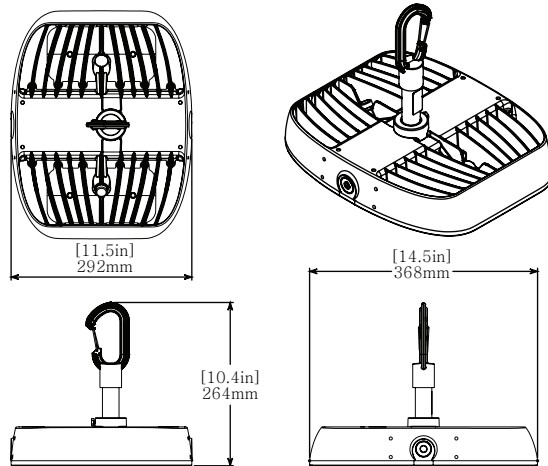

CONDUIT CONNECTION (MR-CC) : 5.3 kg | 11.7 lbs

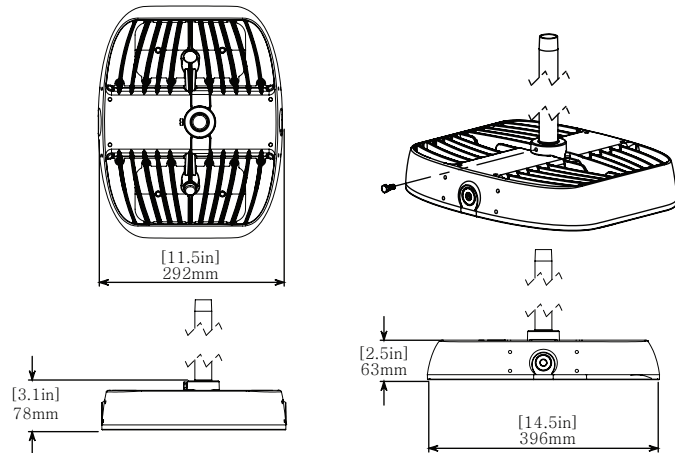

SLIP FITTER YOKE MOUNT (MR-SFY-GY) : 6.55 kg | 14.7 lbs
EPA: 0.13 m² / 1.42 ft²

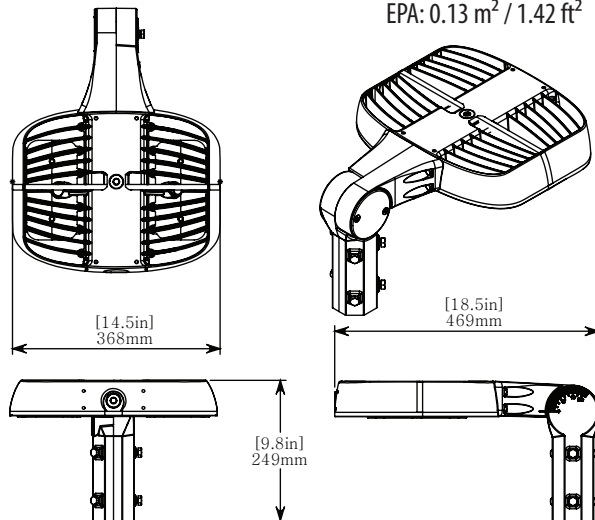

THREADED ADJUSTABLE POLE MOUNT (MR-SFY-1.5) : 6.0 kg | 13.9 lbs
EPA: 0.13 m² / 1.42 ft²

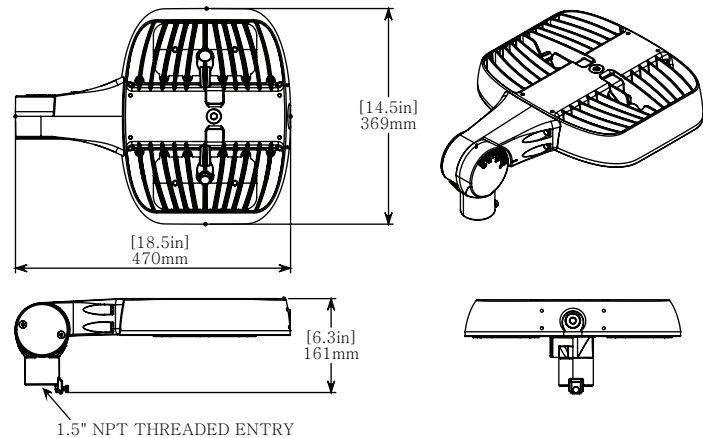

Stepped to accept either 1.5\"/>

SECONDARY SAFETY (MR-SK-##)

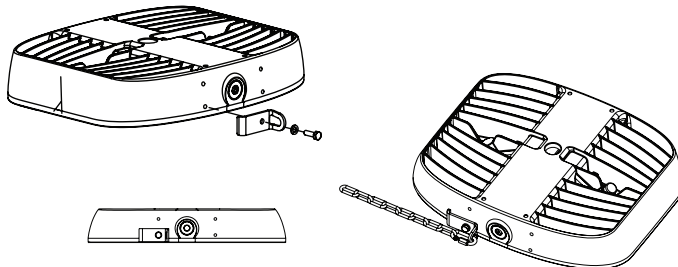

##represents the safety chain length in feet (i.e. 05=5', 10=10').
Secondary Safety Kit contains bracket, stainless steel chain
(1/8 trade size), and two stainless steel oval threaded connecting
links.

ORDERING INFORMATION

| | | |
|------------------|--|------|
| PROJECT NAME | | TYPE |
| PROJECT LOCATION | | |
| COMMENT | | DATE |
| PREPARED BY | | |

MODEL SELECTOR

Sample Number: MR6-50-WF-GY-GN-AC

| MODEL | COLOUR | OPTIC | FINISH | LOCATION | POWER |
|--------------------------------------|---|--|---|------------------------------|--|
| - | - | - | GY - | GN - | - |
| MR3 MR6⁵ | 50 - 5000K Special Order: 27 - 2700K ^{1,3} 30 - 3000K ^{1,3} 35 - 3500K ¹ 40 - 4000K ¹ 45 - 4500K ¹ 57 - 5700K ¹ | WF - Wide Beam (No optics) Special Order: T1F - IESNA Type 1 ¹ T2F - IESNA Type 2 ¹ T3F - IESNA Type 3 ¹ T4F - IESNA Type 4 ¹ T5F - IESNA Type 5 ¹ SF - Spot 18° ¹ TF - Tight 32° ¹ MF - Medium 50° ¹ OF - Oval 26° x 108° ¹ PXF - Asymmetric 20° x 80° w/ 45° forward kick ¹ FNF - Asymmetric 90° x 22° w/ 45° forward kick ¹ 2WF - Asymmetric 135° x 55° w/ 25° forward kick ¹ 3WF - Asymmetric 155° x 55° w/ 30° forward kick ¹ W1F - Asymmetric 150° x 52° w/ 30° forward kick ¹ DNF - Asymmetric 105° x 55° w/ 25° forward kick ¹ XWF - Asymmetric 135° x 170° w/ 75° forward kick ¹ VSF - IESNA Type 5 (Square beam for wide area lighting) ¹ | GY - Grey Custom finishes are available. Please contact for details. ¹ | GN - General Location | AC - 120-277VAC HV - 347VAC |

ACCESSORIES (Order Separately)

Sample Number: MR-WM2-GY

| ACCESSORY | FINISH |
|--|---|
| - | GY |
| MR-SM - Surface Mount ^{2,3} | Custom finishes are available. Please contact for details. ¹ |
| MR-WM2 - Wall Mount 2 ³ | |
| MR-PM - Pole Mount ³ | |
| MR-HK - Hook Pendant Mount | |
| MR-CC - Conduit Connection ³ | |
| MR-YM - Yoke Mount ² | |
| MR-SFY - Slip Fitter Yoke Mount | |
| MR-SFY-1.5 - Threaded Adjustable Yoke Mount | |
| MR-SK-## - Secondary Safety ^{2,4} | |

DLC listed models chart:

| DesignLights Consortium (DLC) v5.1 Qualified LED Luminaire Listings | | | |
|---|--------------------|---------------------|----------------|
| Model No. | Category | General Application | Classification |
| MR6-[50,CW]-WF-xx-yy-[AC,HV]-zz | Outdoor Luminaires | Mid Output | DLC Standard |

OPTIONAL CONTROLS:

EuControls S618-P-DR - Motion and Light Sensing Dimming Control (Optional Remote Control Available), 120/208-240/277 VAC
NOTE #: 800VA Max Load @ 120VAC, 1000VA Max Load @ 208-240VAC, 1200VA Max Load @ 277 VAC

Intermatic EK4136S - Stem Mount Electronic Photo Control, Side Lens, 105-305 VAC
Intermatic EK4236S - Stem and Swivel Mount Photo Control, Side Lens, 105-305 VAC
Intermatic EK4436SM - Die Cast Metal Stem Mount Electronic Photo Control, 105-305V AC
Intermatic EK4736S - Stem and Swivel Mount Photo Control, Top Lens, 105-305 VAC
NOTE #: All Intermatic Photo Controls Max Load 1650 W @ 277VAC

NOTES:

1. Minimum order quantities, additional costs and lead times may apply.
2. Only available in stainless steel finish.
3. IDA Fixture Seal of Approval only applies to fixtures with a CCT of 3000K or less, and have fixed mounts aiming the fixture perpendicular to the ground.
4. ## represents the safety chain length in feet (i.e. 05=5', 10=10').
Secondary safety kit contains bracket, stainless steel chain (1/8 trade size), and two stainless steel oval threaded connecting links.
5. See DLC listed models chart.